

## Carga admisible de carriles/rieles de montaje

La misma carga en 3 puntos

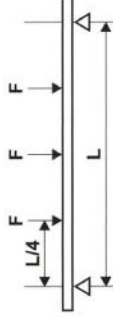

Carga uniforme

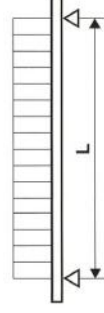

L (mm)	41 x 21		41 x 41		41 x 62		41 x 82	
	1,5 mm	2,5 mm	1,5 mm	2,0 mm	2,5 mm	2,5 mm	2,5 mm	2,5 mm
250	924	1.190	2.714	3.278	3.805	7.365	11.517	
300	770	992	2.261	2.732	3.171	6.138	9.598	
350	660	850	1.938	2.341	2.718	5.261	8.227	
400	578	744	1.696	2.049	2.378	4.603	7.198	
450	513	661	1.508	1.821	2.114	4.092	6.399	
500	462	595	1.357	1.639	1.903	3.683	5.759	
600	385	496	1.131	1.366	1.586	3.069	4.799	
700	306	396	969	1.171	1.359	2.630	4.113	
800	234	303	848	1.024	1.189	2.302	3.599	
900	185	239	754	911	1.057	2.046	3.199	
1.000	150	194	678	820	951	1.841	2.879	
1.200	104	135	565	683	793	1.534	2.399	
1.400	77	99	437	524	613	1.315	2.057	
1.600	59	76	335	401	469	1.151	1.800	
1.800	46	60	264	317	371	1.023	1.600	
2.000	38	48	214	257	300	865	1.440	
2.250	30	38	169	203	237	684	1.280	
2.500	24	31	137	164	192	554	1.146	
2.750	20	26	113	136	159	458	947	
3.000	17	22	95	114	133	385	796	
3.250	14	18	81	97	114	328	678	
3.500	12	16	70	84	98	283	585	
3.750	11	14	61	73	85	246	509	
4.000	-	12	54	64	75	216	448	
4.250	-	11	47	57	67	192	397	
4.500	-	-	42	51	59	171	354	
4.750	-	-	38	45	53	153	317	
5.000	-	-	34	41	48	138	287	
5.250	-	-	31	37	44	126	260	
5.500	-	-	28	34	40	114	237	
5.750	-	-	26	31	36	105	217	
6.000	-	-	24	29	33	96	199	

L (mm)	41 x 21		41 x 41		41 x 62		41 x 82	
	1,5 mm	2,5 mm	1,5 mm	2,0 mm	2,5 mm	2,5 mm	2,5 mm	2,5 mm
250	3.697	4.762	10.854	13.112	15.222	29.460	46.070	
300	3.081	3.968	9.045	10.927	12.685	24.550	38.391	
350	2.640	3.401	7.753	9.366	10.873	21.043	32.907	
400	2.310	2.976	6.784	8.195	9.514	18.413	28.794	
450	2.054	2.645	6.030	7.285	8.457	16.367	25.594	
500	1.848	2.381	5.427	6.556	7.611	14.730	23.035	
600	1.540	1.984	4.523	5.463	6.342	12.275	19.196	
700	1.163	1.503	3.877	4.683	5.436	10.522	16.453	
800	891	1.151	3.392	4.098	4.757	9.206	14.397	
900	704	909	3.015	3.642	4.228	8.183	12.797	
1.000	570	737	2.714	3.278	3.805	7.365	11.517	
1.200	396	512	2.260	2.708	3.170	6.138	9.598	
1.400	291	376	1.660	1.989	2.329	5.261	8.227	
1.600	223	288	1.271	1.523	1.783	4.603	7.198	
1.800	176	227	1.004	1.204	1.409	4.059	6.399	
2.000	143	184	814	975	1.141	3.288	5.759	
2.250	113	146	643	770	902	2.598	5.119	
2.500	91	118	521	624	730	2.104	4.355	
2.750	75	97	430	516	604	1.739	3.599	
3.000	63	82	362	433	507	1.461	3.024	
3.250	54	70	308	369	432	1.245	2.577	
3.500	47	60	266	318	373	1.074	2.222	
3.750	41	52	231	277	325	935	1.936	
4.000	36	46	203	244	285	822	1.701	
4.250	32	41	180	216	253	728	1.507	
4.500	28	36	161	193	225	649	1.344	
4.750	25	33	144	173	202	583	1.206	
5.000	23	29	130	156	183	526	1.089	
5.250	21	27	118	141	166	477	988	
5.500	19	24	108	129	151	435	900	
5.750	17	22	98	118	138	398	823	
6.000	16	20	90	108	127	365	756	

La fuerza máxima (N) en un punto.

Los valores indicados en las tablas se refieren solamente a la potencia de carril/riel de montaje.

La carga máxima admisible de otros elementos de montaje debe ser verificada por separado.

Tabla de cálculos estáticos

Tipo	Peso (kg/m)		Momento de inercia cm <sup>4</sup>		Coeficiente de resistencia cm <sup>3</sup>	
	ly	lz	Wy	Wz		
41 X 21-1,5	1,15	3,70	0,72	1,80		
41 X 41-1,5	1,65	6,20	2,12	3,00		
41 X 21-2,5	1,78	5,40	0,93	2,61		
41 X 41-2,5	2,61	9,30	2,97	4,50		
41 X 62-2,5	3,33	13,20	5,75	6,39		
41 X 82-2,5	4,08	16,89	9,00	8,18		

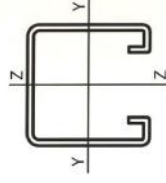

## Carga admisible de carriles/rieles de montaje

Carga en 1 punto

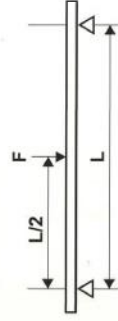

La misma carga en 2 puntos

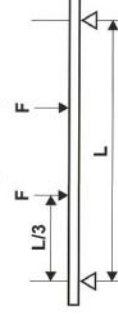

L (mm)	41 X 21		41 X 41		41 X 62		41 X 82	
	1,5 mm	2,5 mm	1,5 mm	2,0 mm	1,5 mm	2,5 mm	1,5 mm	2,5 mm
250	1.848	2.381	5.427	6.556	7.611	14.730	23.035	
300	1.540	1.984	4.523	5.463	6.342	12.275	19.196	
350	1.320	1.701	3.877	4.683	5.436	10.522	16.453	
400	1.155	1.488	3.392	4.098	4.757	9.206	14.397	
450	1.027	1.323	3.015	3.642	4.228	8.183	12.797	
500	924	1.190	2.714	3.278	3.805	7.365	11.517	
600	770	992	2.261	2.732	3.471	6.138	9.598	
700	660	850	1.938	2.341	2.718	5.261	8.227	
800	557	719	1.696	2.049	2.378	4.603	7.198	
900	440	568	1.508	1.821	2.114	4.092	6.399	
1.000	356	460	1.357	1.639	1.903	3.683	5.759	
1.200	247	320	1.131	1.366	1.586	3.069	4.799	
1.400	182	235	969	1.171	1.359	2.630	4.113	
1.600	139	180	794	952	1.114	2.302	3.599	
1.800	110	142	628	752	881	2.046	3.199	
2.000	89	115	508	609	713	1.841	2.879	
2.250	70	91	402	481	564	1.624	2.559	
2.500	57	74	325	390	456	1.315	2.303	
2.750	47	61	269	322	377	1.087	2.094	
3.000	40	51	226	271	317	913	1.890	
3.250	34	44	193	231	270	778	1.611	
3.500	29	38	166	199	233	671	1.389	
3.750	25	33	145	173	203	584	1.210	
4.000	22	29	127	152	178	514	1.063	
4.250	20	25	113	135	158	455	942	
4.500	18	23	100	120	141	406	840	
4.750	16	20	90	108	126	364	754	
5.000	14	18	81	97	114	329	680	
5.250	13	17	74	88	104	298	617	
5.500	12	15	67	81	94	272	562	
5.750	11	14	62	74	86	249	515	
6.000	-	13	56	68	79	228	473	

L (mm)	41 X 21		41 X 41		41 X 62		41 X 82	
	1,5 mm	2,5 mm	1,5 mm	2,0 mm	1,5 mm	2,5 mm	1,5 mm	2,5 mm
250	1.386	1.786	4.070	4.917	5.708	11.048	17.276	
300	1.155	1.488	3.392	4.098	4.757	9.206	14.397	
350	990	1.275	2.907	3.512	4.077	7.891	12.340	
400	866	1.116	2.544	3.073	3.568	6.905	10.798	
450	770	992	2.261	2.732	3.171	6.138	9.598	
500	693	893	2.035	2.459	2.854	5.524	8.638	
600	578	744	1.696	2.049	2.378	4.603	7.198	
700	427	552	1.454	1.756	2.039	3.946	6.170	
800	327	422	1.272	1.537	1.784	3.452	5.399	
900	258	334	1.131	1.366	1.586	3.069	4.799	
1.000	209	270	1.018	1.229	1.427	2.762	4.319	
1.200	145	188	829	993	1.163	2.302	3.599	
1.400	107	138	609	730	854	1.973	3.085	
1.600	82	106	466	559	654	1.726	2.699	
1.800	65	83	368	442	517	1.489	2.399	
2.000	52	68	298	358	419	1.206	2.160	
2.250	41	53	236	283	331	953	1.920	
2.500	33	43	191	229	268	772	1.598	
2.750	28	36	158	189	221	638	1.320	
3.000	23	30	133	159	186	536	1.109	
3.250	20	26	113	135	159	457	945	
3.500	17	22	97	117	137	394	815	
3.750	15	19	85	102	119	343	710	
4.000	13	17	75	89	105	302	624	
4.250	12	15	66	79	93	267	553	
4.500	10	13	59	71	83	238	493	
4.750	-	12	53	63	74	214	443	
5.000	-	11	48	57	67	193	399	
5.250	-	-	43	52	61	175	362	
5.500	-	-	39	47	55	159	330	
5.750	-	-	36	43	51	146	302	
6.000	-	-	33	40	47	134	277	

STRUT Channel  
 41-21-7-S=1.50mm  
 41-21-7-S=2.00mm  
 41-21-7-S=2.50mm

STRUT Channel  
 41-41-7-S=1.50mm  
 41-41-7-S=2.00mm  
 41-41-7-S=2.50mm

STRUT Channel  
 41-62-7-S=2.50mm

STRUT Channel  
 41-82-7-S=2.50mm

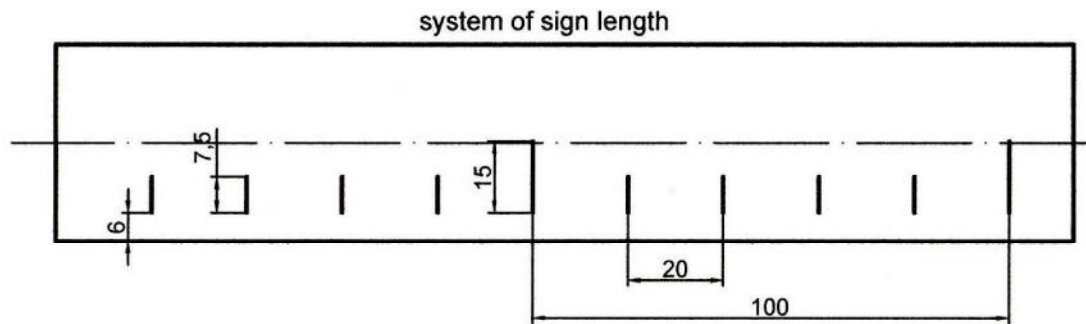
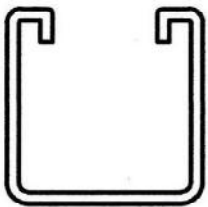
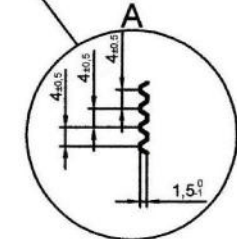
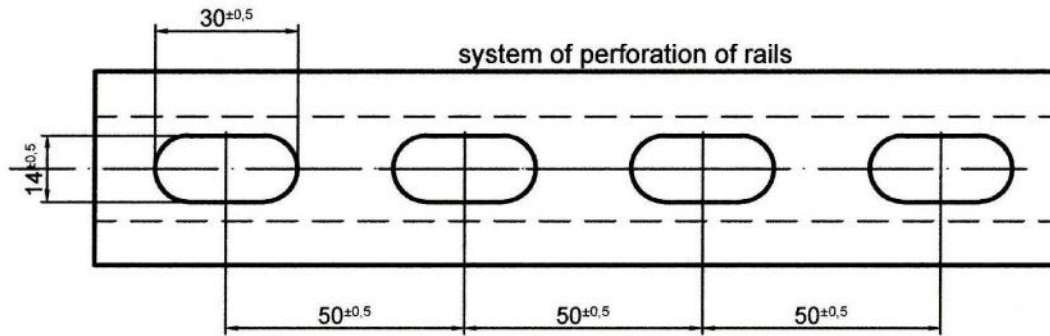
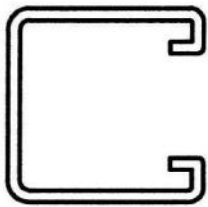
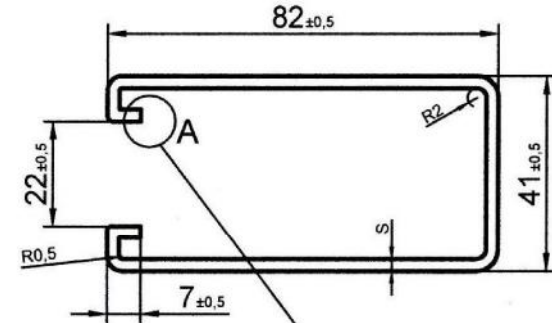
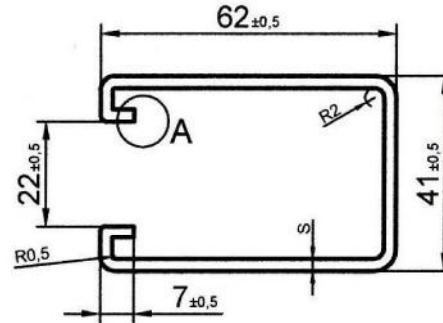
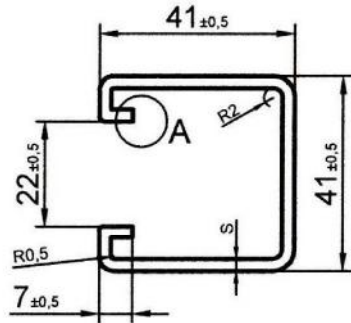
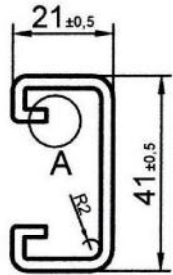

WYSOKOŚĆ	17m	MATERIAŁ	DX51	NORMA MIEJ.	PN-EN 10346	CIĘŻKOŚĆ [mm]	PN-EN 10143
PROSTOCIĄT	0,003 x L	POKRYCIE		NORMA POL.	PN-EN 10346	CIĘŻKOŚĆ [kg/m]	PN-EN 10162
ROZMIAR PROFILU [mm]		WYKONANIE		POPS		WYKONANIE	
≤ 100mm	a1						
> 100mm ≤ 200mm	a2						
> 200mm ≤ 300mm	a3						
> 300mm ≤ 400mm	a4						
> 400mm ≤ 500mm	a5						
> 500mm ≤ 600mm	a6						
> 600mm	a7						
NAZWA PROFILU				SZYNY STRUT 21/41/62/82		RAMI-SYSTEM®	
WYKONANIE				POPS		NEU-6000, S.A.	
SCALA				1:1		DATA WYCENY	
WYKONANIE				A4		DATA WYCENY	
				01		28.02.2013	
						28.02.2013	